

Paul Bunyan Mall

1401 Paul Bunyan Dr NW

Bemidji , MN 56601



Located in the scenic beauty of North Central Minnesota in the City of Bemidji, approximately 220 miles NW of Minneapolis, this mall serves the entire region with a shopping radius of 80 miles. The shopping center consists of 289,792 square feet of leasable area featuring notable retailers such as; Herberger's, JCPenney, JoAnn Fabric, Hobby Lobby, Bath & Body Works, Kohl's and others. The greater Bemidji area, home to over 31,000 residents, is a historically charming, progressive and beautiful north woods community. Bemidji is recognized as the regional, cultural and shopping-medical hub to a vast area covering Northern Minnesota and Southern Manitoba, Canada, thereby, serving a vast trade area. The Bemidji lakes region is a popular tourist destination and home to leading manufacturers of computer components and Bemidji State University with an enrollment of more than 5,000 students.

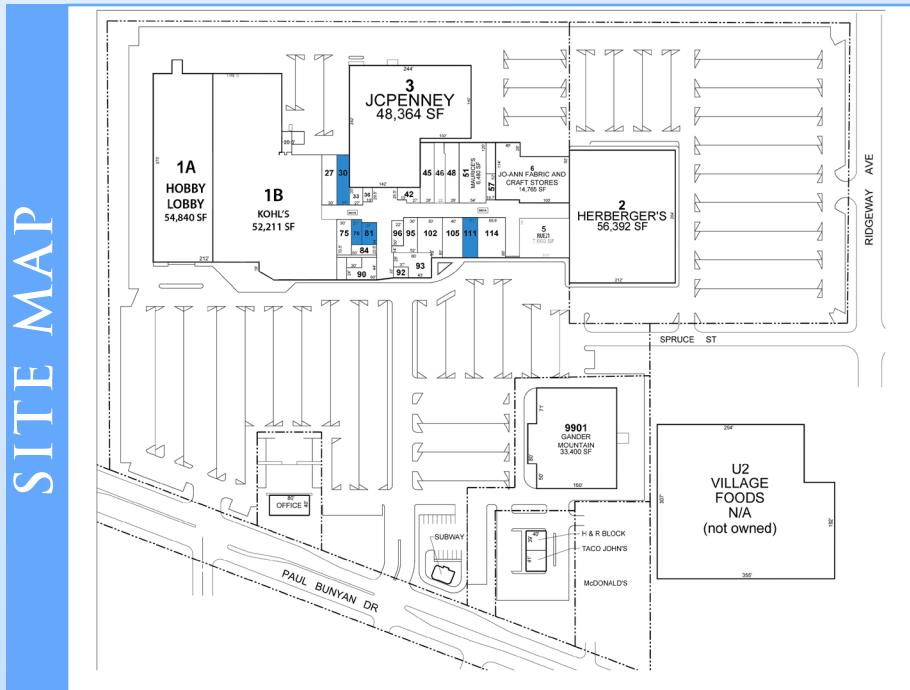

TENANT ROSTER

#	Tenant	S.F.
1A	Hobby Lobby	54,840
1B	Kohl's	52,211
2	Herberger's	56,392
3	JCPenney	48,364
5	Rue21	7,660
6	JoAnn Fabric and Crafts	14,765
27	Foot Locker	3,000
30	Available	2,533
33	Regis Salon	962
36	Pretzelmaker	560
42	Dairy Queen	1,521
45	Tradehome Shoes	3,403
46	Kirby Photography	2,597
48	Vanity	3,403
51	Maurices	6,480
57	Claire's	1,000
75	Terra Reflections	2,115
78	Available	1,000
81	Available	1,320
84	GNC	1,025
90	CosmoProf	2,056
92	NY Nails	814
93	Circus Arcade	3,186
95	Bath & Body Works	2,494
96	Riddle's Jewelry	966
102	Christopher & Banks	3,685
105	Glik's	3,200
111	Available	2,400
114	Famous Footwear	4,448
9901	Gander Mountain	33,400

FOR LEASING INFORMATION CONTACT:



Leasing • Managing • Consulting

Sol Reichenberg, *Director of Leasing*
Lexington Realty International, LLC

911 East County Line Rd.

Lakewood, NJ 08701

Phone: 732.415.6884

Email: sol@lexingtonco.com

LEASABLE AREA

Total Square Feet	289,792 sq ft
Square Footage Available	7,253 sq ft
Anchors (Total)	5
Herberger's	56,392
JCPenney	48,364
JoAnn Fabric and Crafts	14,765
Hobby Lobby	54,840
Kohl's	52,211

ANCHORS



PROPERTY DATA

Opening Date	1978
Levels	1
Acres	26.92
Parking	1,700 spaces

TRADE AREA 10 MILES 20 MILES 30 MILES

Population	31,264	42,828	55,554
2015 Population Projection	32,785	44,448	57,378
Total Households	11,449	15,764	21,140
Average Household Income	61,459	59,072	56,525
Median Household Income	47,627	46,561	44,447
Median Age	33.6	34	35.8

INTERIOR PHOTOS



Paul Bunyan Mall

1401 Paul Bunyan Dr NW Bemidji, MN 56601